

Manual

Roastilino



Overview



Preparing for Installation

A Requirements for installation

The Roastilino must be placed on a hard, flat non flammable surface.

WARNING: The Roastilino must never be placed on a table cloth or similar surface.

It is highly recommended that adequate extraction for smoke is provided, this can be achieved by means of a suitable extractor fan.

- * **NOTE:** The appliance must be installed in a location where it can be overseen by trained personnel and its use and maintenance is restricted to trained personnel.
- * **NOTE:** The appliance must be installed on a suitably strong, stable and level surface.
- * **NOTE:** The appliance must be kept in a location where the ambient temperature is between 5°C and 30°C

B Connecting power supply

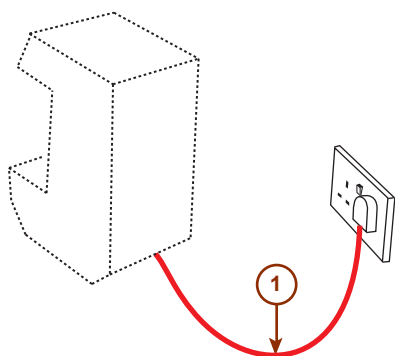

1. Take the mains power cord and plug in to a standard 13Amp socket. Ensure the appliance is within 1metre of the power socket and has easy access for power isolation.

Turning on Operation

A Turning on

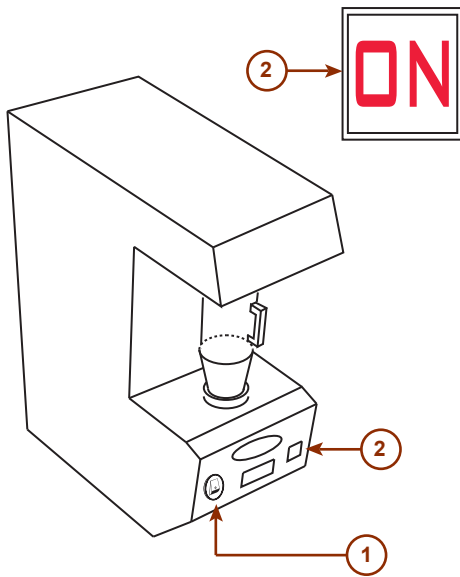

1. Turn on the main on/off switch
2. The LED display will read "ON"

B Operation

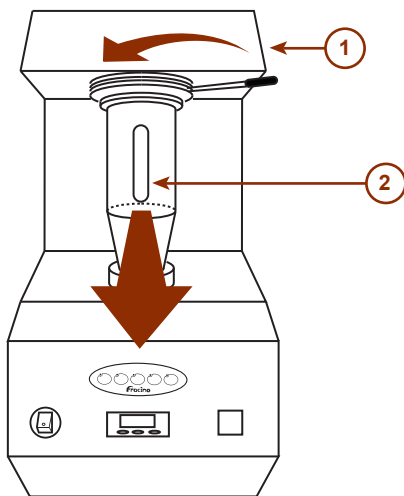

1. Release the jug clamp mechanism by turning the jug clamp handle to the left.
2. Pull the jug forward using the jug handle.
3. Place green beans into the jug

 **WARNING:** Do not put more than 220grams of beans into the jug, too much will prevent the beans from lifting, which will cause them to burn.

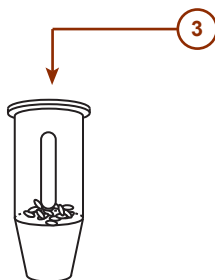

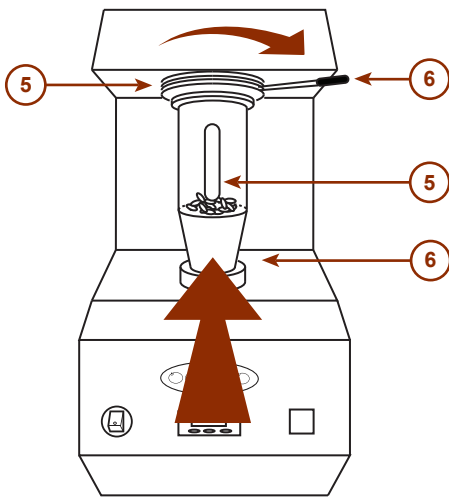

5. Holding the jug in one hand, slide it in to the top rails and push back until it will not go any further, ensuring that the bottom of the jug is in line with the fitting below, otherwise it will not lock correctly.

6. With the other hand, move the jug clamp lever to the right to lock the jug in to the fitting.

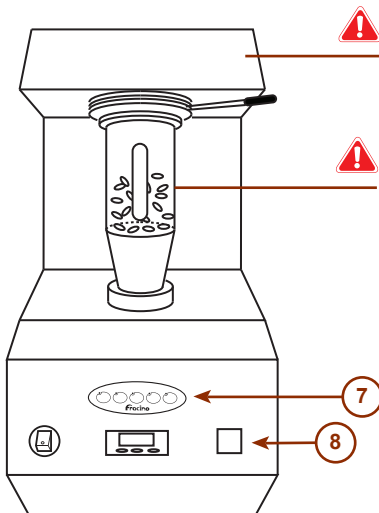

7. Select the roasting time, using the touch pad buttons, see below for button functions.

8. Once a button has been pressed the fan will start and a 5 second count down will appear on the LED display, when it reaches zero the roasting will start. The LED display will then show a count down of the roasting time, when this reaches zero the display will start 2 minute countdown which is the cooling cycle. Once the roasting and cool down is complete the LED display will read "ON" at which point the jug can be removed.

WARNING: The jug and top panel will become hot during use and after roasting take care to avoid burning.

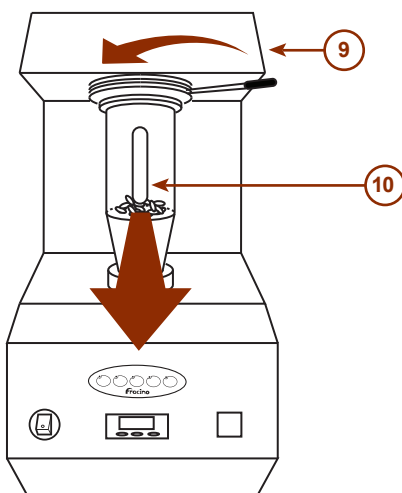

9. Release the jug using the jug clamp handle

10. Pull the jug forward using the handle, take care as the jug and beans will still be hot

11. Empty the beans into bags or a grinder for immediate use.

Touch pad Programming

(A) Button functions

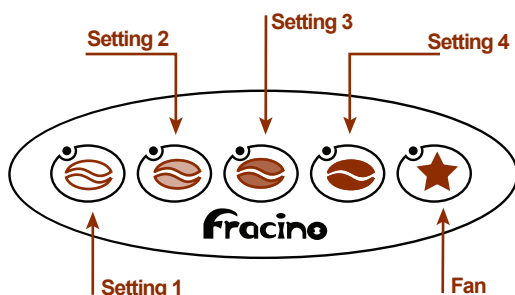

Setting 1: Roasting time 3min - Lightest roast

Setting 2: Roasting time 3min 30Sec

Setting 3: Roasting time 4min

Setting 4: Roasting time 4min 30Sec - Darkest roast

Fan: Starts the fan, can be used to further cool the beans or to create an aesthetic appeal

***** NOTE: The longer the roast time - the higher the roast - the darker the beans. Ensure that only the correct weight of coffee beans are used in order to keep consistency and coffee quality.

(B) Programming

The roasting times can be altered as follows:

1. Switch off at the mains.
2. Press and hold the FAN button and the switch on at the mains.
3. Continue to hold the FAN button for a further 5 seconds
4. Press roasting button you wish to alter.
5. The LED above the button will begin the flash and the display will show the previous roasting time
6. Press the FAN button, the time will increase in increments of 10seconds up to 9.5 and roll over to 0.1.
7. Re-press the roasting button to save the time.
8. Pressing the same roasting button again will store the new time and put the unit in to its ready mode.
9. To program other settings repeat from STEP 1.

(C) Loading Factory Settings

This function will load factory default settings for all the roasting buttons as above.

1. Switch off at the mains
2. Press and hold the FAN button and switch on at the mains
3. Hold the FAN button for a further 10seconds until the display flashes "Pr"
4. Continue holding the FAN button for a further 10seconds until the display flashes "FS"
5. The unit will automatically load the factory settings as above
6. Switch the mains off and then back on again to resume normal operation.

Temperature Control If Fitted

A Setting Roasting Temperature

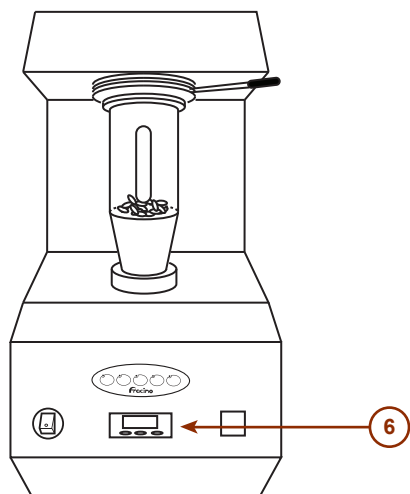

If a temperature controller has been fitted, you can adjust the roasting temperature as follows:

1. Press the "SET" button on the temperature control unit
2. Within 4 seconds use the "UP" and "DOWN" arrows to select the required temperature.
3. When at the required temperature press the "SET" button again to confirm.

* NOTE: The temperature can only be set between 200°C and 235°C

Troubleshooting

FAULT

1. No LED Display
2. Beans do not lift when roasting time has started and fan is running
3. Nothing happens when roast time is started
4. Clamping mechanism is stiff
5. Jug will not go in.
6. Fan runs but with no heat
7. Heat but no fan

REMEDIES

1. No power, check appliance is plugged in and fuse is OK
2. a. Too many beans in jug, check weight and refill jug with the correct weight of beans.
b. Check air intake mesh under the appliance is clear.
3. Check jug is located correctly, check microswitch is depressed when the jug is locked in position.
4. Clean and lubricate clamping thread/mechanism.
5. Check jug clamp lever is all the way to the left.
6. Check heater fuse on main board - to be performed by qualified electricians only.
7. Check fan motor on main board - to be performed by qualified electricians only.

Cleaning

(A) Daily Cleaning

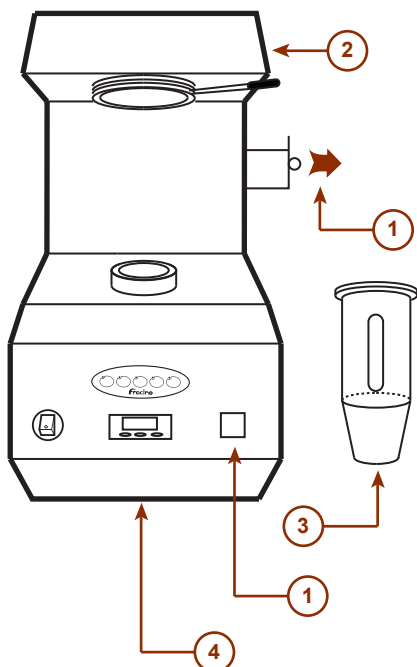

1. After 10 roasts the husk drawer must be emptied, the LED display will flash "Ed" prompting the user to empty the drawer.

* NOTE: It is essential that the drawer is emptied as required, failure to empty the drawer will result in husks being left in the jug and coffee and not being blow out.

2. Wipe the outer case with a soft damp cloth, do NOT use a scouring pad or bleach based cleaners - doing so will damage the surface finish of the appliance.

3. Remove and clean the jug in warm soapy water and a soft cloth to prevent the build up of oils and coffee residue. Do NOT use a scouring pad or bleach based cleaners. Dry the jug with a soft cloth immediately after cleaning.

4. Carefully tilt the machine backward and gently clean the wire mesh that covers the fan air intake with a soft cloth or a soft brush. Failure to do this will result in poor fan performance which can cause the heating element to over heat, leading to early failure of the element.

* NOTE: Failure to clean and maintain this appliance correctly may void the warranty.

⚠ WARNING: Do not immerse this appliance in water for cleaning

(B) Weekly Cleaning

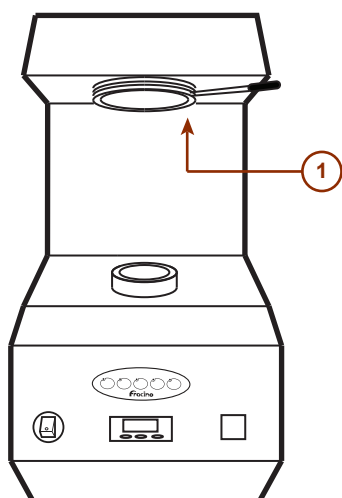

1. Apply food safe silicon grease/spray to the thread, available from Fracino. Remove the Jug, lock the clamping lever to the right and put grease on the thread between the top of the mechanism and the small flat plate.

* NOTE: Failure to do this will cause the mechanism to seize

Warnings

1. At no time should anything be removed to expose wires, removing body panels can result in a dangerous electric shock.
2. Always treat the machine with respect, do not use if the machine has been dropped, vandalized or otherwise damaged, if in doubt contact your supplier or Fracino Direct on 0121 328 5757
3. Do not allow unqualified personnel to tamper with your machine.
4. Your machine should have a regular service.
5. Care must be taken when roasting - beans, the jug and top panel will become hot during roasting
6. Do not operate this appliance without adequate training.
7. If the supply cord or plug is damaged, it must be replaced by the manufacturer, its service agent or similarly qualified persons in order to avoid a hazard.
8. Children should be supervised to ensure they do not use or play with the appliance.
9. This appliance is not intended for use by persons (including children) with reduced physical, sensory or mental capabilities, or lack experience and knowledge, unless they have been given supervision or instruction concerning use of the appliance by a person responsible for their safety.
10. The appliance must not be cleaned with a water jet, or located in an area where a water jet could be used.
11. Disconnecting, by passing, tampering with or otherwise interfering with safety valves, high limit thermostats or other safety or control devices may cause serious injury and/or damage to the appliance.
12. The appliance must not be immersed in water for cleaning.

Disposal

This appliance must not be disposed of as normal household waste, contact your local authority for suitable Waste Electronic and Electrical Equipment (WEEE) recycling facilities. Alternatively, return the appliance to Fracino where it will be disposed of in a responsible manner.

V2.3



Fracino Birch Road East, Birmingham, B6 7DB, Great Britain.
Website / www.fracino.com Email / sales@fracino.com
Tel / +44 (0)121 328 5757



The Fracino company policy is one of continuous improvement. We retain the right to change specification without prior notice.